

- Approval subject to:-
1. Strict compliance of construction building plans without any deviation.
  2. Architectural drawings / building plans with respect to current building regulations. All documents are considered as records for the project.
  3. Responsibility of stability and safety to be born by the owner / Architect / Geotechnical Engineer / L.B.S. / Structural Engineer.
  4. Before commencement of any construction, it should be confirmed that the building plan along with the conditions is in order with respect to the site measurement and necessary approval from the concerned authority, such as pollution, fire, etc. (West Bengal Municipal Corporation Building Act).
  5. Entire cost of the work to be borne by the owner. The responsibility of the owner.
  6. Dumping of construction material, mixing of mortar etc. On adjoining the road & land are not permitted.

2/20/2021  
 P. Kamalakar, IFS  
 Executive Director  
 West Bengal Industrial  
 Development Corporation Ltd.  
 23, Abanindranath Tagore  
 Sarani (Cantonment), Kolkata - 700 017

APPROVED  
 01/11/2021

11/11/2021

**SCHEDULE OF DOORS & WINDOWS**

TYPE	WIDTH	HEIGHT	SILL HEIGHT	UNTEL HEIGHT	REMARK
D1	1050	2000	00	2000	ENTRY TO UNITS
D2	900	2000	00	2000	BEDROOMS
D3	750	2000	00	2000	TOILET
D4	1500	2000	00	2000	ENTRANCE LOBBY
DW1	750-900	2560	00	2560	BALCONY(BEDROOM)
DW2	750-1200	2560	00	2560	BALCONY(LIVING)
DW3	750-750	2560	00	2560	BALCONY(BEDROOM)
DW4	750-600	2560	1050	2560	BALCONY(KITCHEN)
W1	900	1660	900	2560	BEDROOM
V1	600	1000	1000	2000	TOILET
FCD	1500	2000	00	2000	STAIRCASE

PLAT DETAILS:  
 ARCHITECTURAL DRAWINGS OF PROPOSED 5+13 STORED APARTMENT BUILDINGS FOR AFFORDABLE HOUSING PROJECT OF M/S IABA HOUSING PVT. LTD. IN AEROTROPOLIS TOWNSHIP AT ANDAL, NEAR DURGAPUR OVER, LR PLOT NO.- 5650 (part), 5708 (part), 5710 (part), 5711 (part), 5712 (part), 5713 (part), 5714 (part), 5716 (part), 5718 (part), 5719 (part), 5720 (full), 5721 (part), 5722 (part), 5723 (part), 5724 (full), 5728 (part), 5729 (part), 5730 (part), 5731 (full), 5732 (full), 5733 (full), 5734 (full), 5735 (full), 5736 (full), 5737 (full), 5738 (full), 5739 (full), 5740 (part), 5741 (full), 5742 (part), 5743 (part), 5744 (full), 5745 (full), 5746 (part), 5747 (part), 5748 (part), 5749 (part), 5752 (part), 5753 (part), 5754 (part), 5758 (part), 5820 (part), 5822 (part) & 5718/7748 (part) LR KHATA NO.- 3893, J.L. NO.- 36, MOUZAL- DAKSHINKHANDA, UNDER P.S.- ANDAL, DIST.- BURDWAN, WEST BENGAL.

GIAN P. MATHUR AND ASSOCIATES (P) LTD.  
 C-35, East of Kailash, New Delhi-110065  
 T: 46599999 | F: 46599312  
 E: info@gpmindia.com | W: www.gpmindia.com  
 ARCHITECTS

SERVICES CONSULTANT:  
**Consummate Engineering Services (P) Ltd.**  
 Head Office: 51-45, Sector-45, Noida-201301  
 Tel: (9120) 2320500 (10 Lines)  
 Lko. Office: R-006, Rohtak Plaza, Conna Nagar, Lucknow  
 E-mail: mail@cespl.in, website: www.cespl.in

- SPECIFICATIONS:-**
1. GRADE OF CONCRETE FOR SUB STRUCTURE IN PILE & PILE CAP WILL BE M30 AND FOR SUPER STRUCTURE IN BEAMS & SLAB M25 AND FOR SHEAR WALLS & COLUMNS AS PER COLUMN SCHEDULE DRAWINGS. AS PER IS:456:2000.
  2. P.C.C. WORK IN M-10 GRADE CONCRETE.
  3. REINFORCEMENT STEEL - Fe-500 CONFIRMING TO IS:1786-2008.
  4. MINIMUM COVER OF CONCRETE :
    - (a) FOUNDATION = 50 mm.
    - (b) COLUMN = 40 MM.
    - (c) SHEAR WALL = 30 MM.
    - (d) BEAM = 30 mm.
    - (e) SLAB = 20 mm.

- NOTES:-**
1. ALL DIMENSIONS ARE IN mm, CHAINAGE AND LEVELS ARE IN m. UNLESS OTHERWISE NOTED.
  2. ALL STRUCTURAL DRAWINGS BE READ IN CONJUNCTION WITH ARCHITECTURAL DRAWINGS.
  3. HEIGHT OF THE BUILDING IS 42.85 m.
  4. ALL EXTERNAL WALLS 230 MM THK & ALL INTERNAL WALLS 115 MM. THK.
- LEGEND**
- BRICK WORK IN BURNT CLAY BRICKS
  - BRICK WORK IN FLYASH BRICKS
5. INTERNAL ROAD IS 450 MM ABOVE FROM EXTERNAL ROAD.

IABA HOUSING PVT. LTD.  
 CLUBT: 5 GORKY TERRACE, 2nd FLOOR, KOLKATA, WEST BENGAL-700017

SIGNATURE OF REVIEWER  
  
**SANJIB GUHA**  
 STRUCTURAL CONSULTANT  
 BSC, BQE, P.E. Chartered Engineer  
 Structural & M.E. (C.E.)  
 Registration No. E-15 (1) 0819  
 Enrolment No. 19641  
 Enrolment No. 19641/2009

SIGNATURE OF STRUCTURAL ENGINEER  
  
**CHANDNI PRASAD KHANRA**  
 BE (Civil), ME (Struct), MIE (India)  
 ES-1/2

SIGNATURE OF GEOTECHNICAL ENGINEER  
  
**RUPAK KUMAR BANERJEE**  
 B.C.E., M.E., MGS, M.I.E.,  
 G. T/13 (K.M.C.), BWGEO-TECH/1002,  
 018/RUP SONG/2014-15, GTER-HDCO/09/00014  
 GEOWSDIC20190002

CONSULTANT/ARCHITECT'S SIGNATURE  
  
**GIAN P. MATHUR**  
 ARCHITECT  
 B. Arch., M.C.A.I.A.  
 CA No. 80/5769

SIGNATURE OF LOCAL ARCHITECT'S SIGNATURE  
  
**AR. JUI CHATTERJEE, B-ARCH**  
 Registration No: CA/2021/13432  
 Ph: 9324049399, 7535934111  
 4/13, Subhata Commercial Complex,  
 City Centre, Durgapur-713216

SIGNATURE OF OWNER

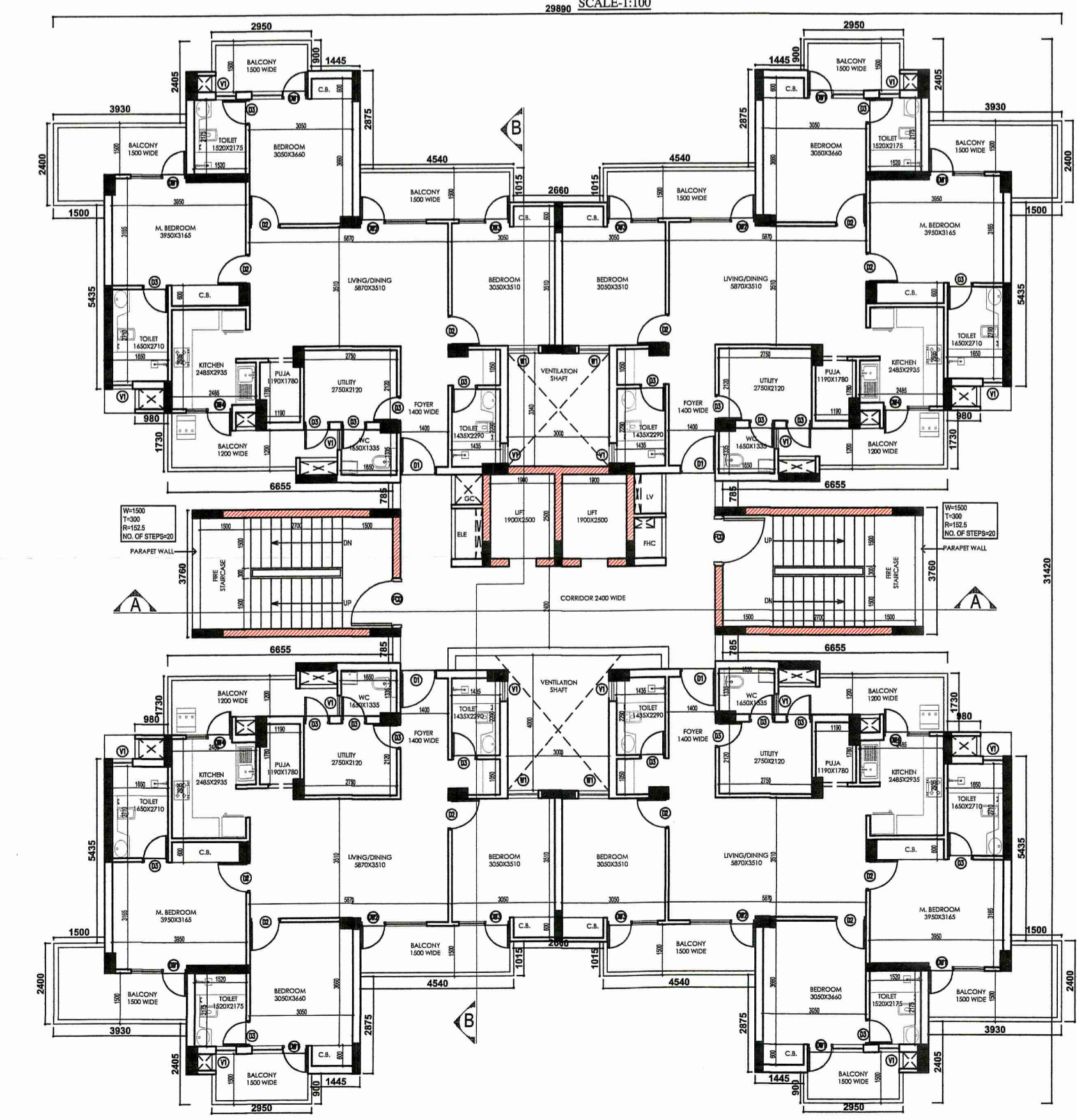

5TH FLOOR PLAN  
 SCALE:1:100

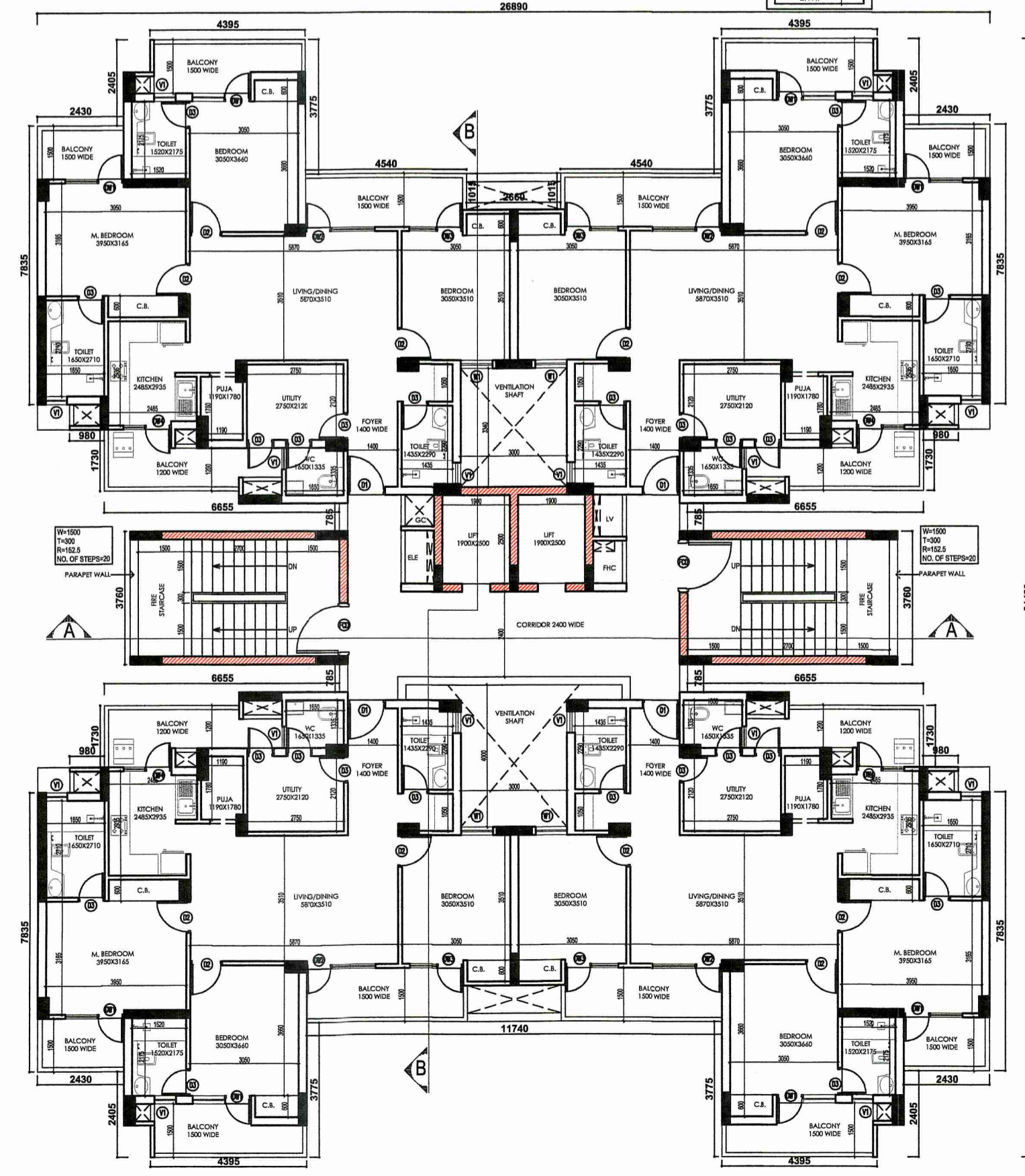

6TH & 11TH FLOOR PLAN  
 SCALE:1:100

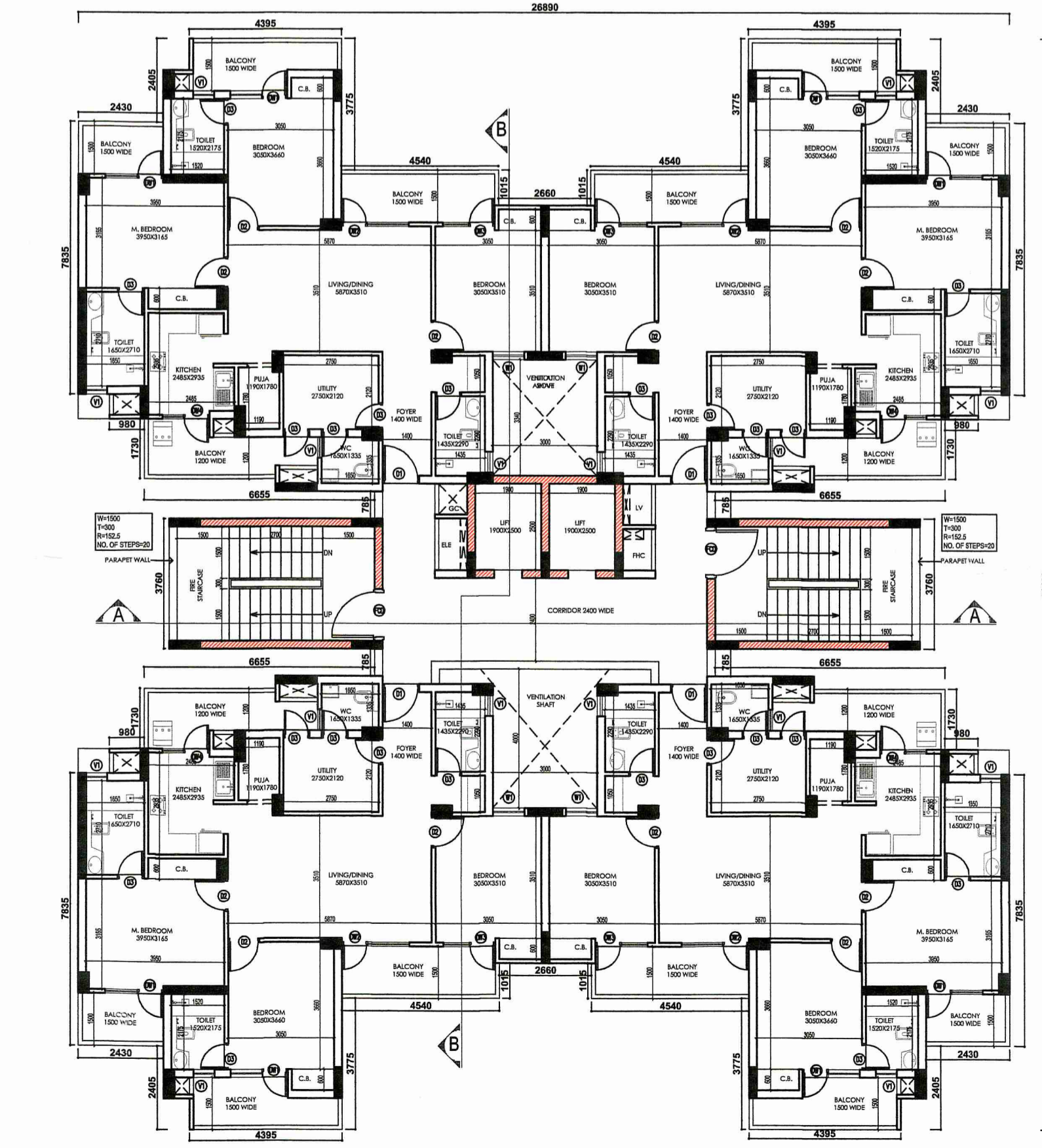

7TH & 10TH FLOOR PLAN  
 SCALE:1:100

TITLE	TYPICAL FLOOR PLANS & ELEVATION, SECTION TOWER - 1A (MIG-III)	DRAWN	SIG.
SHEET NO.	DURG-ME-28-06	CHECKED	SIG.
DATE	13/01/2021	SCALE	1:100